

1				2				3				4				5				6			
																REVISIONS							
																REV.	DESCRIPTION		DATE	APP.			
																A	Added eK0 to vehicle list		24-3-2022	JWI			
																All rights remain with TRIPOD MOBILITY BV. This applies especially to rights of invention, know-how, copyrights and rights to name as well as for the rights to patent these as commercial protective rights. All rights of disposition, particularly for copying or distributing reserved. Approval of first supply and change according to TRIPOD MOBILITY BV.							
																Drawn by Date Department		B. Verhallen 7-11-2017 Homologation		Notes - Measurements in mm - Tolerance ±0.5mm - Homologation drawing, prior to modification please consult Homologation department -LHD and RHD			
																Material -		Weight 779396.26 [g]					
																Homologation number HOM-062-PCT3?							
																Car(s) -Citroën SpaceTourer/Jumpy Long (SF/EV) 2020- -Peugeot Traveller/Expert Long (SF/EV) 2020- -Opel Zafira/Vivaro Long (SF/EV) 2020- -Toyota PROACE VERSO/PROACE Long (SF/EV) 2020-							
																Title Seat belt anchorage points detail, wheelchair occupant							
																Subgroup Seating							
																No.		Scale 1:30	Sheets 1 of 2	A4	Part No. 16462a		

</

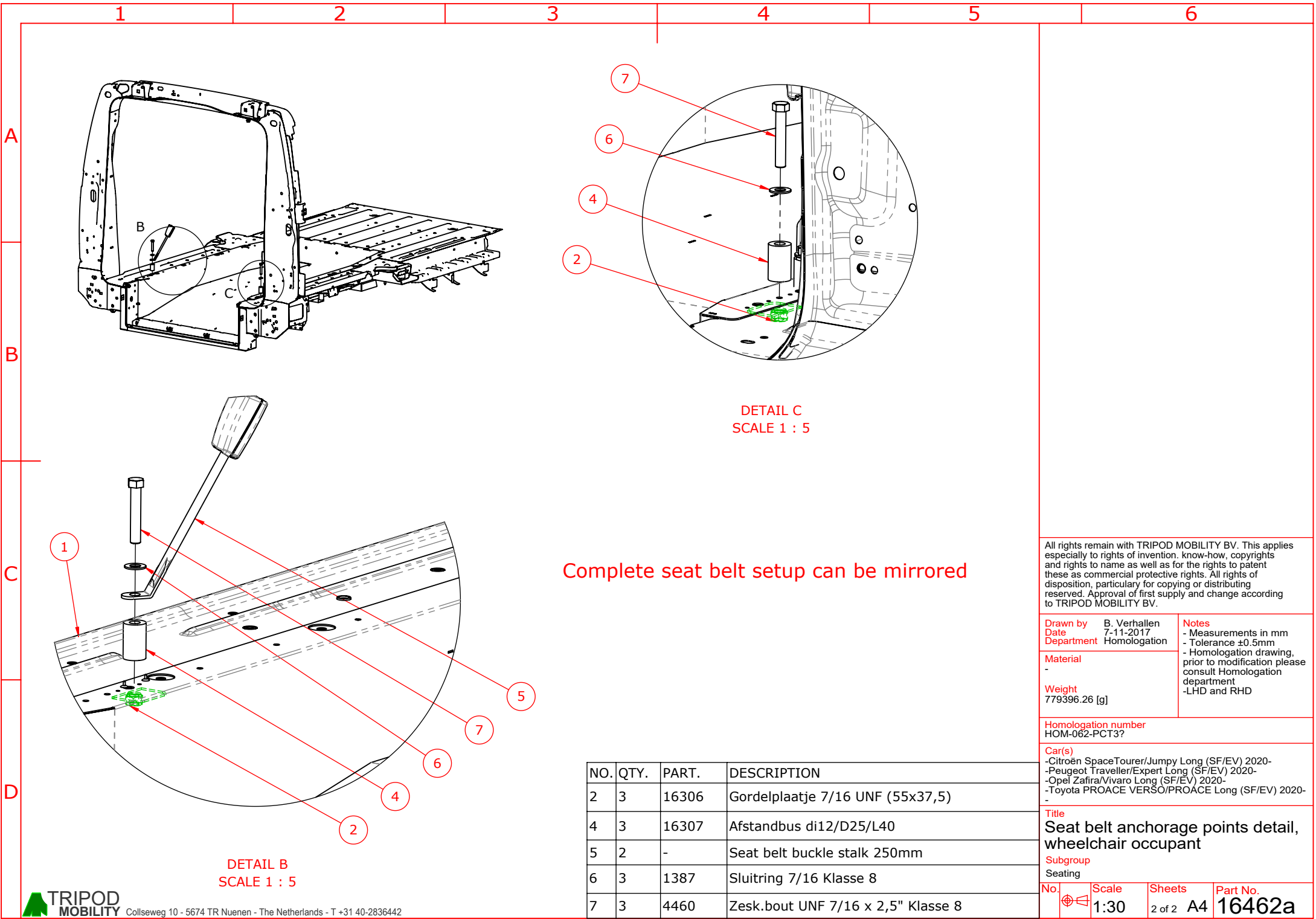

<